

ANDERSON GREENWOOD AMAL LER/LERC/LEF/LEFC FLAME ARRESTERS

Lightweight end-of-line deflagration flame arresters designed to prevent the propagation of a flame with subsonic speed

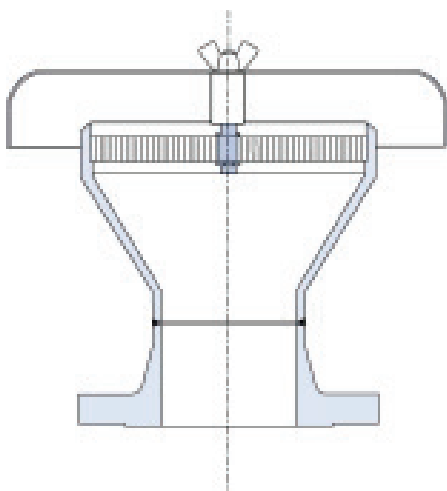

FEATURES

- Weather cowled or non-cowled model variants available.
- Fabricated design.
- Lightweight construction.
- Advanced crimped stainless steel element construction as standard. Other materials available.
- Independently tested and certified.
- Manufactured to ISO 9001:2008

GENERAL APPLICATION

The LER and LEF are mounted on tanks or on the end of discharge pipes to stop flames entering the process. The LEF's 1:1 inlet to element ratio design makes it ideal for low cost, low pressure drop applications.

TECHNICAL DATA

Materials:	Carbon steel, stainless steel
Sizes:	DN 6 to 400 (1/8" to 16")
Connections:	Threaded or flanged
Temperature range:	-20° to +60°C (-4° to +140°F)*
Gas groups:	IIA, IIB1, IIB2, IIB3, IIB, IIC
Certification:	ATEX Directive 94/9/EC

* Temperatures up to 200°C (392°F) available for certain gas groups.

ANDERSON GREENWOOD AMAL LER/LERC/LEF/LEFC FLAME ARRESTERS

MATERIALS AND CONNECTION OPTIONS

Materials

Carbon steel and stainless steel.

Connection pipe size

Threaded

LER/LERC: DN 6 to 50 (½" to 2")

Flanged

LER/LERC: DN 15 to 400 (½" to 16")

LEF/LEFC: DN 40 to 400 (1½" to 16")

NOTE

Accessories, special materials and connections are available on request.

Gas groups

- IIA
- IIB1
- IIB2
- IIB3
- IIB
- IIC

HIGH TEMPERATURE (+200°C (+392°F)) APPLICATIONS

Explosion group	Gap width	Inlet size
IIB1 (IIA)	0.8 mm (0.032")	DN 15 - 600 (½" - 24")
IIB	0.45 mm (0.018")	DN 15 - 600 (½" - 24")
IIB2, IIB3	0.6 mm (0.024")	DN 15 (½") only
IIC	0.3 mm (0.012")	DN 15 (½") only

NOTES

All sizing and selection must be conducted by the factory.

Standard LER/LERC elements are double the pipe size.

LEF/LEFC elements are 1:1.

LEFC (LC VERSION)

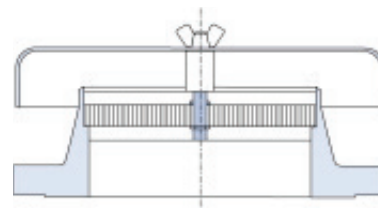

LERC (LC VERSION)

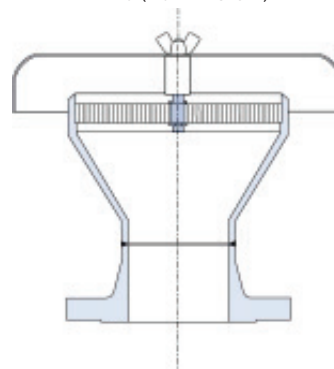

LEF (LE VERSION)

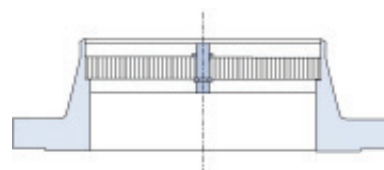

LER (LE VERSION)

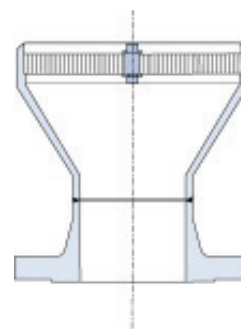

ANDERSON GREENWOOD AMAL LER/LERC/LEF/LEFC FLAME ARRESTERS

SELECTION GUIDE

Example:	LER	50	LE	100	19	80	S3	S3
Model								
LER								
LERC								
Connection diameter, mm (in)								
Threaded								
DN 6 to 50 (1/8" to 2")								
Flanged								
DN 15 to 400 (1/2" to 16")								
Element code								
LE								
LC								
Element diameter, mm (in)								
DN 25 to 100 (1" to 4") - threaded connection								
DN 25 to 600 (1" to 24") - flanged connection								
Element width, mm (in)								
19 19 mm (0.75")								
Cell height, mm (in)								
80 0.80 mm (0.032")								
60 0.60 mm (0.024")								
45 0.45 mm (0.018")								
15 0.15 mm (0.006")								
Element material								
S3 Stainless steel								
C Carbon steel								
Body material								
S3 Stainless steel								
C Carbon steel								

SELECTION GUIDE

Example:	LEF	50	LE	100	19	80	S3	S3
Model								
LEF								
LEFC								
Connection diameter, mm (in)								
DN 40 to 400 (1 1/2" to 16")								
Element code								
LE								
LC								
Element diameter, mm (in)								
DN 40 to 400 (1 1/2" to 16")								
Element width, mm (in)								
19 19 mm (0.75")								
Cell height, mm (in)								
80 0.80 mm (0.032")								
60 0.60 mm (0.024")								
45 0.45 mm (0.018")								
15 0.15 mm (0.006")								
Element material								
S3 Stainless steel								
C Carbon steel								
Body material								
S3 Stainless steel								
C Carbon steel								

Neither Emerson, Emerson Automation Solutions, nor any of their affiliated entities assumes responsibility for the selection, use or maintenance of any product. Responsibility for proper selection, use, and maintenance of any product remains solely with the purchaser and end user.

Anderson Greenwood is a mark owned by one of the companies in the Emerson Automation Solutions business unit of Emerson Electric Co. Emerson Automation Solutions, Emerson and the Emerson logo are trademarks and service marks of Emerson Electric Co. All other marks are the property of their respective owners.

The contents of this publication are presented for informational purposes only, and while every effort has been made to ensure their accuracy, they are not to be construed as warranties or guarantees, express or implied, regarding the products or services described herein or their use or applicability. All sales are governed by our terms and conditions, which are available upon request. We reserve the right to modify or improve the designs or specifications of such products at any time without notice.

Emerson.com/FinalControl