

PDA3400 Internally Mounted Plastic UL Type 4X Enclosures

Data Sheet



Download free 3-D CAD files of these enclosures to simplify your drawings!

predig.com/documentation-cad

PDA3407 Enclosure Shown with a ProVu Meter and MOD-LHRB1 Red Light/Horn and Button.

Meter & Light/Horn Sold Separately. Assembly Required.

FEATURES

- House up to 3 Instruments
- Plastic
- 1/8 DIN and 1/4 DIN cutouts available
- Instrument Mounted Behind Clear Cover
- UL Type / NEMA 4X
- Mounting Hardware Provided
- UL, C-UL Listed
- Light/Horn & Button
- Pipe Mounting Kit Available

OVERVIEW

The PDA3400 series of internally mounted plastic UL Type / NEMA 4X enclosures for 1/8 DIN Digital Panel Meters and 1/4 DIN PID Controllers provide a convenient way to mount one, two or three Precision Digital meters / controllers to walls and other vertical structures. The PDA3400 series enclosures provide a greater degree of protection than other Precision Digital enclosures because the meters / controllers are mounted behind a clear polycarbonate cover. These enclosures also have room for a light/horn accessory. They also come pre-cut with 1/8 DIN or 1/4 DIN cutouts or they can be ordered with no cutouts / front plate. Mounting hardware is provided. The cover is secured with four screws. Pipe mounting kit is available for mounting the enclosures to 2" pipes. Enclosures, meters / controllers and accessories are ordered and packaged separately.

WALL MOUNTING

The PDA3400 enclosures include four mounting flanges and four screws. Using the included screws and a Phillips head screwdriver simply assemble each flange in the four threaded screw holes on the back of the enclosure as shown in the example below.



Front view of a PDA3400 series enclosure with supplied mounting flanges installed



Rear view of a PDA3400 series enclosure with supplied mounting flanges installed



The PDA3400 series enclosures is supplied with 4 screws and 4 mounting flanges

ENCLOSURE SELECTION UTILITY

This utility simplifies the selection process of the right enclosure for your application based on the number and type of instruments to be installed in the enclosure. Below is a step-by-step overview of how this utility works.

STEP 1. Select number of instruments

Select the total number of instruments to be installed in the enclosure from the drop down menu.

STEP 2. Select cutout configuration

Select the cutout configuration desired for the enclosure. Choose from horizontal, vertical, or dual configurations as shown in the examples below for a 4 cutouts configuration.

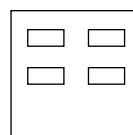

4 Horizontal

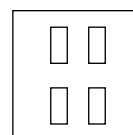

4 Vertical

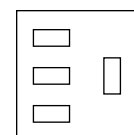

3 Horizontal
1 Vertical

STEP 3. Select type of instruments

Select the type of instrument(s) that will be installed into the enclosure. Below is an overview of the types of instruments supported.



For more information about instrument types see the enclosure Specifications or hover over an image while using the Enclosure Selection Utility.

STEP 4. Choose enclosure from results

SKU	Description	Stock	Lead Time	Price
PDA2304	PDA2300 Series NEMA 4X Plastic Enclosures Enclosure Cutouts: Four (4) Material: Plastic Meter Mounting: Through front panel Orientation: Horizontal Warranty: 1 year Approvals: UL/UL-UL	3	3 business days	\$269.00
PDA2504	PDA2500 Series Plastic NEMA 4X Enclosures Enclosure Cutouts: Four (4) DIN Rail: 1/8 DIN Material: Plastic Meter Mounting: Through front panel Orientation: Horizontal Warranty: 1 year Approvals: UL/UL-UL	1	13 business days	\$349.00
PDA2604	PDA2600 Series Stainless Steel NEMA 4X Enclosures Enclosure Cutouts: Four (4) Material: Stainless Steel Meter Mounting: Through front panel	1	23 business days	\$699.00



Need help selecting
the right enclosure?
www.predig.com/esu

MODELS AVAILABLE

Cutouts



PDA3407



PDA3408



PDA3411



PDA3411-1



PDA3412



PDA3414

No Cutouts



PDA3412-B



Need help selecting
the right enclosure?
www.predig.com/esu

MOUNTING AN INSTRUMENT INSIDE PDA3400 ENCLOSURE

1. Mount the instrument by placing it through the cutout on the mounting plate. Secure the instrument with the mounting brackets included with the instrument.

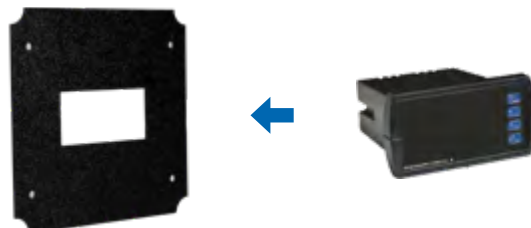

2. Take the mounting plate with the instrument and screw it onto the enclosure box by lining up the four screw holes on the plate to the four mounting rods shown on the inside of the enclosure.

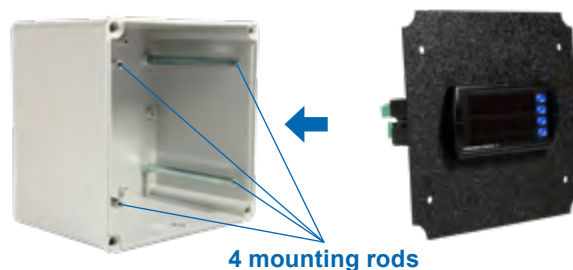

4 mounting rods

3. Screw the clear cover onto the front of the enclosure using the four white plastic screws included with the PDA3400.



Instrument fully installed
in enclosure

Instrument shown behind
clear cover



ACCESSORIES

PDA3400 Series Enclosure with Light/Horn

Transform Precision Digital meters and controllers housed in an enclosure into an efficient display, control, and alarm system with the MOD-LH series. It provides a light/horn to boost visibility of alarm conditions, a button that connects to the meter's digital input to control or reset the alarms, and hole drilling on the enclosure for both the light/horn and button to make user installation and wiring quick and easy. Enclosure and meter are sold separately.

The MOD-LH series is compatible with a wide range of Precision Digital UL Type / NEMA 4 & 4X enclosures as well as meters and controllers including the ProVu, Trident, Loop Leader, and ConsoliDator+ Series.

Overall, the MOD-LH series is a simple solution for Precision Digital meters and controllers that adds audible and visual ways to indicate critical alarms.

What's Included

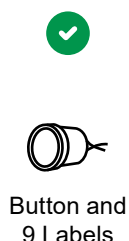

ProVu Meter Shown in a PDA3407 Enclosure with MOD-LHRB1 Red Light/Horn and Button.

Meter & Enclosure Sold Separately. Assembly Required.

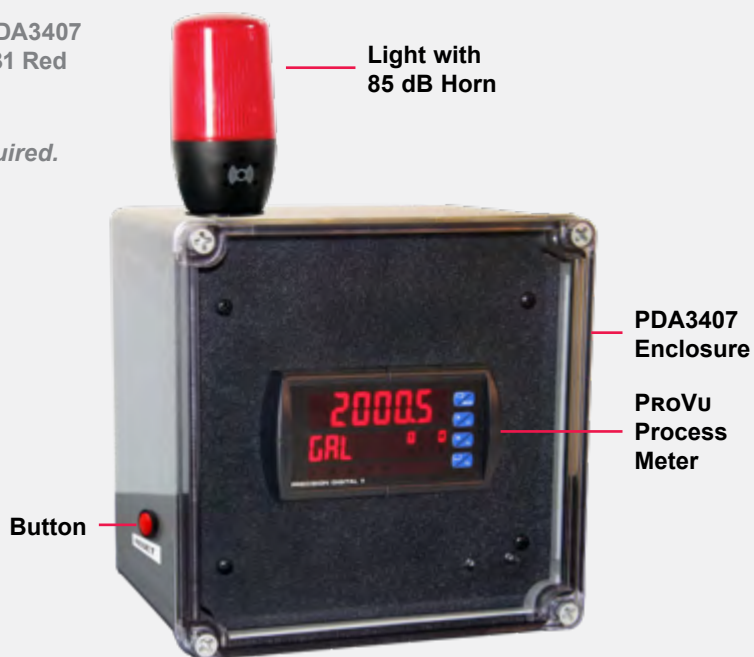

ACCESSORIES (CONTINUED)



PDA6845-SS 2" Pipe Mounting Kit

The PDA6845-SS pipe mounting kit provides convenient ways to mount PDA3400 enclosures to 2" pipes. The kit can be oriented either horizontally (as shown) or vertically (to accommodate 1/8 DIN vertical instruments.)



PDA-SSTAG Stainless Steel Tags

PDA-SSTAG is a laser etched stainless steel tag accessory for any Precision Digital meters / controllers. The tag features custom text for equipment identification, instruction, or whatever else is needed in your facility. Each tag comes with a stainless steel wire and lead seal for easy mounting wherever you need it.



PDX18DIN-FILLER 1/8 DIN Cutout Filler

The NEMA 4X 1/8 DIN cutout filler is used to cover up empty 1/8 DIN cutouts and maintain the NEMA 4X rating to the panel or enclosure. It consists of a generic bezel with a black faceplate, as well as mounting brackets, gasket, etc.



PDA-BUTTON Momentary Pushbutton

The PDA-BUTTON Series are IP67 fully sealed momentary pushbuttons that can be used for a variety of applications, such as resetting the manually-resettable relays on various Precision Digital meters. They are available with red, black and green buttons.



Button Labels

The button comes with 9 pre-printed message labels the user can affix under the button: RESET, BATCH, ACK, TARE, SILENCE, STOP, START, PAUSE, START/STOP.



MOD-BUTTON Pushbutton with Hole Drilled in Enclosure

When this is ordered, the enclosure comes pre-drilled with a hole for pushbutton to be installed by user. Enclosure is sold separately. The pushbutton is centered on the side of the enclosure about an inch off the bottom. For mounting in different locations, order items separately and drill holes and mount as desired. Other pushbutton colors are available.

SPECIFICATIONS

General

Material: Plastic

Color: Body: Gray; Cover: Clear polycarbonate plastic

Instruments: Houses up to 3 meters / controllers

Instrument Mounting Method: Behind clear window

Cover Mounting Method: Screws

Ratings: UL Type / NEMA 4X

Approvals: UL, C-UL

Operating Temperature: -40 to 120°C

Warranty: 1 year

Instrument Types

Type	Instruments
C	PD603, PD644, PD743, PD765, PD6602, PD6603, PD6604, PD6606, PD6607, PD6608, PD6622, PD6624, and PD6626, and PD6628.
D	PD138, PD154, PD158, and PD520
E	PD6000, PD6001, PD6060, PD6080, PD6081, PD6088, PD6089, PD6100, PD6200, PD6210, PD6262, PD6300, PD6310, PD6310-WM, PD6363, PD6400, and PD7000
F	PD530

Dimensions / Features

• Available ■ 1 Required

Model	# of Cutouts	Instrument Type				Outside Dimensions (H x W x D) Inch (mm)	Inside Dimensions (H x W x D) Inch (mm)	Mounting Dimensions Inch (mm)	Conduit Hole	Fits PDA1024-01	Fits Light/Horn	Weight lb (kg)
		C	D	E	F							
1/8 DIN Horizontal Cutouts												
PDA3407	1	•	•	•		7.9 x 7.9 x 6.3 (201 x 201 x 160)	7.5 x 7.5 x 5.0 (190 x 190 x 127)	7.125 x 9.75 (181 x 248)			•	3.1 (1.4)
PDA3411	2											
PDA3411-1	1	•	•	•								
PDA3412	3											
PDA3414	2	•	■	•								
1/4 DIN Cutouts												
PDA3408	1				•	7.9 x 7.9 x 6.3 (201 x 201 x 160)	7.5 x 7.5 x 5.0 (190 x 190 x 127)	7.125 x 9.75 (181 x 248)			•	3.1 (1.4)
No Cutouts												
PDA3412-B	N/A					7.9 x 7.9 x 6.3 (201 x 201 x 160)	7.5 x 7.5 x 5.0 (190 x 190 x 127)	7.125 x 9.75 (181 x 248)			•	3.1 (1.4)

DIMENSIONS

Units: Inches (mm)

All Enclosures

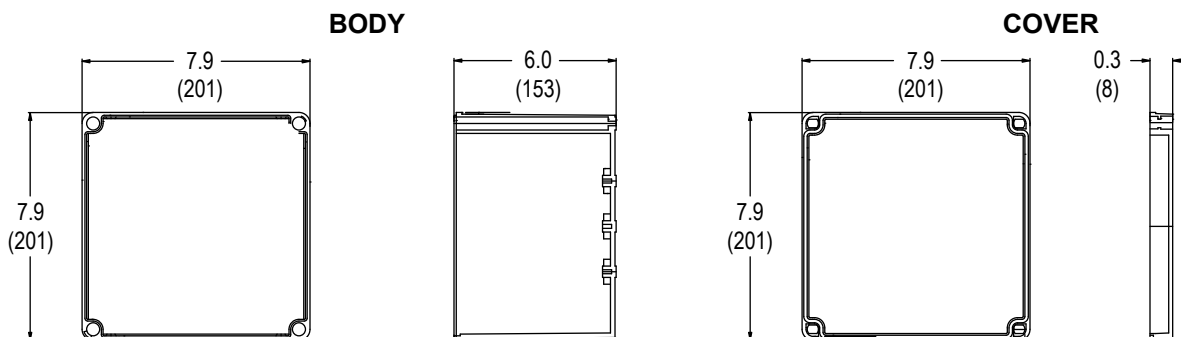

Dimensions for: PDA3407, PDA3408, PDA3411, PDA3411-1, PDA3412, PDA3412-B, PDA3414.



Download free 3-D CAD files of these enclosures to simplify your drawings!

predig.com/documentation-cad

ORDERING INFORMATION

Horizontal Cutouts

Model	# of Cutouts	Instrument Type				
		B	C	D	E	F
PDA3407	1	•	•	•	•	
PDA3408	1					•
PDA3411	2	•	•	•	•	
PDA3411-1	1	•	•	•	•	
PDA3412	3	•	•	•	•	
PDA3414	2	•	•	■	•	

• Available ■ 1 Required

Instrument Types

Type	Instruments
B	PD542, PD543, and PD562
C	PD603, PD644, PD743, PD765, PD6602, PD6603, PD6604, PD6606, PD6607, PD6608, PD6622, PD6624, and PD6626, and PD6628.
D	PD138, PD154, PD158, and PD520
E	PD6000, PD6001, PD6060, PD6080, PD6081, PD6088, PD6089, PD6100, PD6200, PD6210, PD6262, PD6300, PD6310, PD6310-WM, PD6363, PD6400, and PD7000
F	PD530

No Cutouts

Model	Description
PDA3412-B	Enclosure with no Cutouts

Accessories

Model	Description
MOD-BUTTON1B-P	IP67 Blue ⁽³⁾ Pushbutton ⁽²⁾ with Hole Drilled in Plastic Enclosure
MOD-BUTTON1G-P	IP67 Green ⁽³⁾ Pushbutton ⁽²⁾ with Hole Drilled in Plastic Enclosure
MOD-BUTTON1R-P	IP67 Red ⁽³⁾ Pushbutton ⁽²⁾ with Hole Drilled in Plastic Enclosure
MOD-LHRB1	Red ⁽³⁾ Light/Horn + Button with Holes Drilled ⁽¹⁾ in Enclosure
PDA-LHR	Red ⁽³⁾ Light/Horn
PDA-BUTTON1R	Red ⁽³⁾ Button ⁽²⁾
PDA-SSTAG	Stainless Steel Tag
PDA6845-SS	2" Pipe Mounting Kit, Stainless Steel
PDX18DIN-FILLER	1/8 DIN Cutout Filler

1. When a MOD-LH is ordered, the enclosure comes pre-drilled with holes for Light/Horn and Button to be installed by user. Meter / controller and enclosure are sold separately. The Light/Horn hole is located on the top in the back left corner of the enclosure and the button hole is on the left side of the enclosure. **For mounting in different locations, order items separately and drill holes and mount as desired.**

2. The Button works only with meters / controllers that have digital input contacts.

3. For other color options see corresponding instruction manual.

WARNING

Cancer and Reproductive Harm - www.P65Warnings.ca.gov

PRECISION DIGITAL CORPORATION

233 South Street • Hopkinton MA 01748 USA • Tel (800) 343-1001



Need help selecting the right enclosure?
www.predig.com/esu



Download free 3-D CAD files of these enclosures to simplify your drawings!

predig.com/documentation-cad



Your Local Distributor is:

Disclaimer

The information contained in this document is subject to change without notice. Precision Digital Corporation makes no representations or warranties with respect to the contents hereof, and specifically disclaims any implied warranties of merchantability or fitness for a particular purpose.

©2024 Precision Digital Corporation. All rights reserved.

LDS3407-14_K 11/24

**PRECISION
DIGITAL**

www.predig.com