



ARCHON model KB Weld Pad Sightglasses

**Section
Bulletin
Issued
Page**

**2003
1001
01/08
011**

ARCHON model KB Weld Pad Sightglasses

KB units are designed to be welded on. The lower weld pad is available in many alloys and is 150# rated standard. Higher rated units are available. Plate flanges used in the manufacturing of our sightglasses are from ASME Section VIII acceptable materials.

The lower weld pad can be provided with a cylindrical or spherical curve to match the vessel or tank, eliminating the need for special nozzles and expensive saddles.

KB units conform to section VIII of the ASME Boiler and Pressure Vessel Code.

Available options include:

Low Pressure Wiper
High Pressure Wiper
Non-Hazardous Lighting Units
Spray Wash Systems



Standard Models

KB50 3" view
KB80 4" view
KB125 6" view
KB150 7" view
KB200 9" view

Special configurations are always available to meet customer requirements.

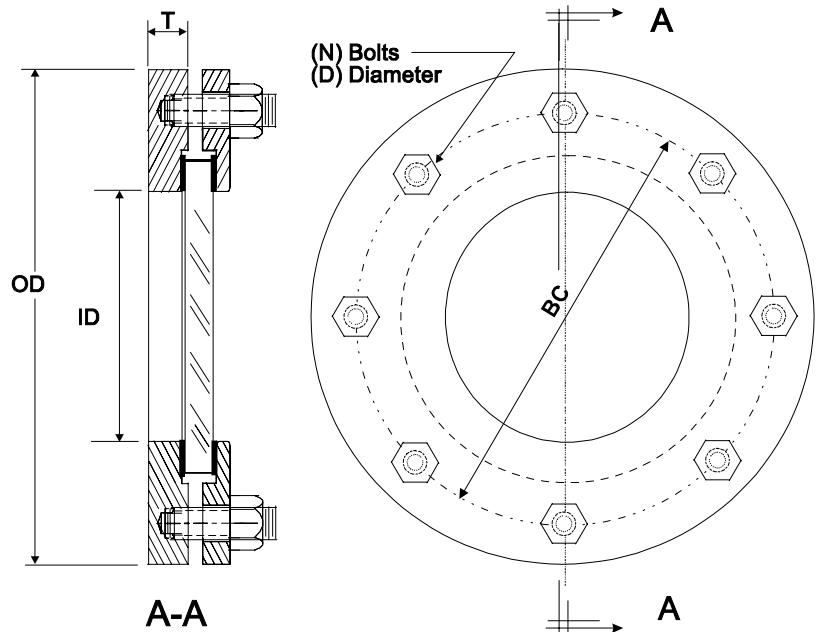

| Model | OD | ID | BC | N | D | T | Maximum Pressure |
|--------|---------|-------|---------|---|------|--------|------------------|
| KB-50 | 7" | 3.25" | 5-1/2" | 4 | 5/8" | 1.187" | 150 psig |
| KB-80 | 7-1/2" | 4" | 6" | 4 | 5/8" | 1.187" | 150 psig |
| KB-100 | 9" | 5" | 7-1/2" | 8 | 5/8" | 1.187" | 150 psig |
| KB-125 | 10" | 6" | 8-1/2" | 8 | 3/4" | 1.437" | 150 psig |
| KB-150 | 11" | 6.87" | 9-1/2" | 8 | 3/4" | 1.437" | 125 psig |
| KB-200 | 13-1/2" | 8.81" | 11-3/4" | 8 | 3/4" | 1.437" | 125 psig |

(800) 554-1394

www.ARCHONind.com

ARCHON Industries, Inc.
357 Spook Rock Road, Suffern NY 10901
www.ARCHONind.com

fax: (845) 368-3040

sales@ARCHONind.com