

ANDERSON GREENWOOD AMAL NP/NPC FLAME ARRESTERS

End-of-line deflagration flame arresters designed to prevent the propagation of a flame with sub-sonic speed

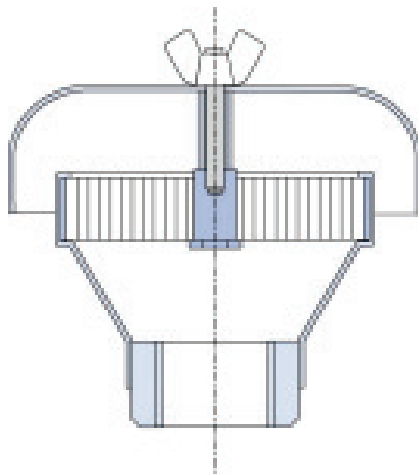

FEATURES

- Weather cowled or non-cowled model variants available.
- Fabricated design.
- Lightweight construction.
- Advanced crimped stainless steel element construction as standard. Other materials available.
- Independently tested and certified.
- Manufactured to ISO 9001:2008.

GENERAL APPLICATION

The NP/NPC end-of-line flame arresters are mounted on tanks or on the end of discharge pipes to stop flames entering the process. With their light weight, low cost body they are ideal for small breather applications where a flame arrester is required.

TECHNICAL DATA

Materials:	Carbon steel, stainless steel
Sizes:	DN 6 to 80 (1/8" to 3")
Connections:	Threaded or plain
Temperature range:	-20° to +60°C [-4° to +140°F]
Gas groups:	IIA, IIB1, IIB2, IIB3, IIB, IIC
Certification:	ATEX Directive 94/9/EC

ANDERSON GREENWOOD AMAL NP/NPC FLAME ARRESTERS

MATERIALS AND CONNECTION OPTIONS

Materials

Carbon steel and stainless steel.

Connection pipe size

Threaded DN 6 to 50 (1/8" to 2")

Plain DN 32 (1 1/4")

DN 40 (1 1/2")

DN 80 (3")

NOTE

Accessories, special materials and connections are available on request.

Gas groups

- IIA
- IIB1
- IIB2
- IIB3
- IIB
- IIC

SELECTION GUIDE

Example:	NP	50	NP	100	19	80	S3	S3
Model								
NP								
NPC								
Connection diameter, mm (in)								
Threaded								
DN 6 to 50 (1/8" to 2")								
Plain								
DN 32 (1 1/4")								
DN 40 (1 1/2")								
DN 80 (3")								
Element code								
NP								
NC								
Element diameter, mm (in)								
DN 50 (2")								
DN 80 (3")								
DN 100 (4")								
Element width, mm (in)								
19 19 mm (0.75")								
Cell height, mm (in)								
80 0.80 mm (0.032")								
60 0.60 mm (0.024")								
45 0.45 mm (0.018")								
15 0.15 mm (0.006")								
Element material								
S3 Stainless steel								
C Carbon steel								
Body material								
S3 Stainless steel								
C Carbon steel								

NOTES

All sizing and selection must be conducted by the factory.

Standard elements are double the pipe size.

NPC SCREWED (NC VERSION)

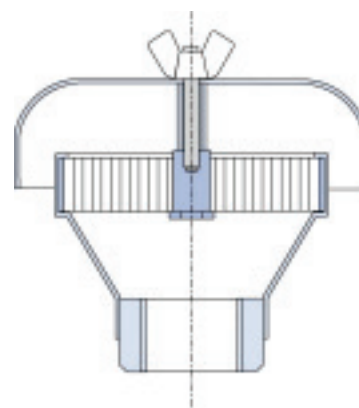

NP SCREWED (NP VERSION)

